

TATWEEER^{MISR}
CREATING DESTINATIONS

Fouka bay

IL MONTE
GALALA
SOKHNA

D-bay
SAHEL

Bloomfields

Arafa Group

Textiles & Garments Companies

- Golden Tex
- Swiss Garments Co.
- Egyptian Tailoring Co.
- Middle East Tailoring Co. (METCO)
- BMB
- CONCRETE
- SIGNIORE for trading and Marketing

Investment Companies

- Arafa Holding co.
- ECRT – The Egyptian Company for Real estate developments and Tourism investments
- AA Hotels and Resorts
- Private Real Estate Projects
- Green Systems Isolation.
- Arafa Group Outlet Malls.

Daoud Group

- Ahmed Daoud & Co. for Engineering and Trade Agencies
- M.Ahmed Daoud & Co. for Electrical and Mechanical Industrial “Madico”.
- M. Ahmed Daoud & Co. for Engineering and Industrial Investments.
- Egyptian Arab Pumps Co.
- AL-FARID CO. for Marketing of Engineering Equipment
- Madico for Real Estate and Property Development

Ahram Group

- Ahram Security Group
- Ahram Marketing & Trading
- Tech Lock For Precision Industries
- New Hi-Tech Lock For Precision Industries

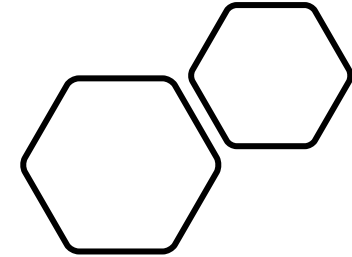

IL MONTE GALALA

Location	Ain Sokhna Mountains
Total Land Size	2.2 million m2
Launch	September , 2015
Completed by	2025
Delivery to Start	2019
Total Residential Units	Around 6,000
Total Hotel Keys	1,000
Total Investment	8 Billion EGP
Construction Start Date	Q1 2016
Coastal Front	1 300 m
Number of Hotels	5



FOUKA BAY

Location	Ras El Hekma, North Coast
Total Land Size	1 million m ²
Launch	September , 2015
Completed by	2020
Delivery to Start	2018
Total Residential Units	Around 1,000
Total Hotel Keys	1,000
Total Investment	2 Billion EGP
Construction Start Date	2015
Beach Front	800 m



BLOOMFIELDS

Location	Al Mostakbal City
Total Land Size	415 feddans
Launch	March , 2018
Completed by	2027
Delivery to Start	2022
Total Residential Units	Around 10,000
Total Investment	33 Billion EGP
Construction Start Date	2019

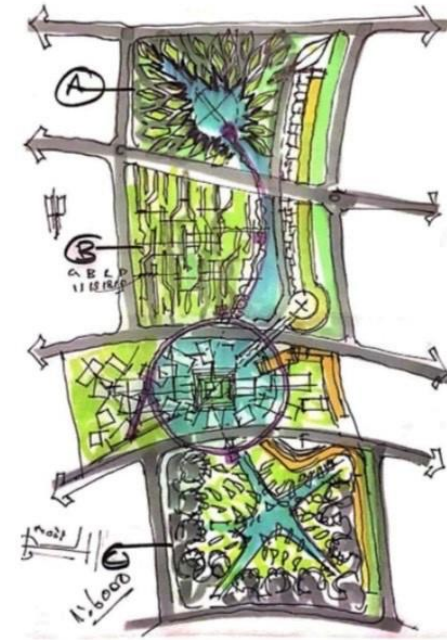

D-bay
SAHEL

Fouka bay

Marsa Matruh

Almaza Bay

Ras El Hekma

Caesar

Swan Lake

La Vistay Bay

Telal

Hacienda

Seashell

Marassi

Diplo

North Edge

El Alamein

Alexandria

Cairo Alex Desert Road

Al Alamein Road

Al Dabaa Road

Cairo

Bloomfields

New Cairo City

Suez

IL MONTE
GALALA
SOKHNA

Live

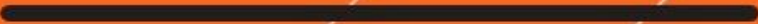



EMBRACING THE FUTURE

MOSTAKBAL CITY

Masterplanned over an impressive 11,000 acre field, as a fully-integrated city comprising of 5 phases; Mostakbal City dedicates 50% of its total land area to green open spaces, and is built to accommodate more than one million inhabitants. The project offers an innovative and futuristic vision for integrated community living, attracting Egypt's top developers, and investors who not only wish to benefit from its lush landscapes, safe road networks, and solid infrastructure, but most importantly its strategic location that sets it as a future economic hub, as well as a major business and residential centre. Nestled between New Cairo's Golden Square, and Cairo's New Capital, while enjoying a close proximity to Al Ein Al Sokhna, Mostakbal City provides an exclusive invitation for Egypt's renowned developers to offer signature addresses in what is about to become New Cairo's soulful extension.

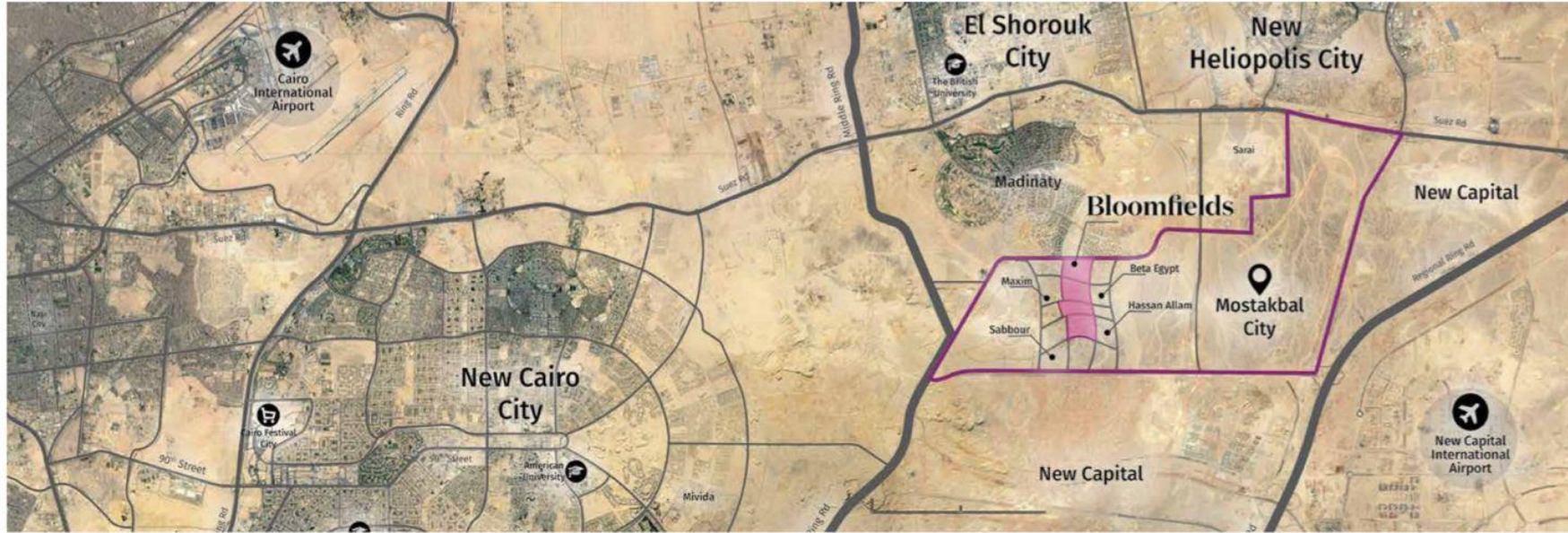

IN THE HEART OF IT ALL
BLOOMFIELDS

Between New Cairo's Golden Square, and Cairo's New Capital, not only offering easy access to Egypt's top-educational institutions such as, the American University In Cairo and Road 90's lively happenings, but also providing direct access to New Cairo Capital's fast train station and International Airport. The project also enjoys a strategic location just 45 minutes away from Al Ein El Sokhna, and can be easily accessed via the Middle Ring Road, and the Regional Ring Road.

Location

- Strategically Located in a unique spot at Cairo Suez Road between km 46 and km 51 East Cairo , Fringed By Bustling cities such as Madinaty , El Sherouk ,New Capital , Mostakbal city can be easily accessed via the regional Ring Road , the Middle Ring Road and Cairo Suez road.

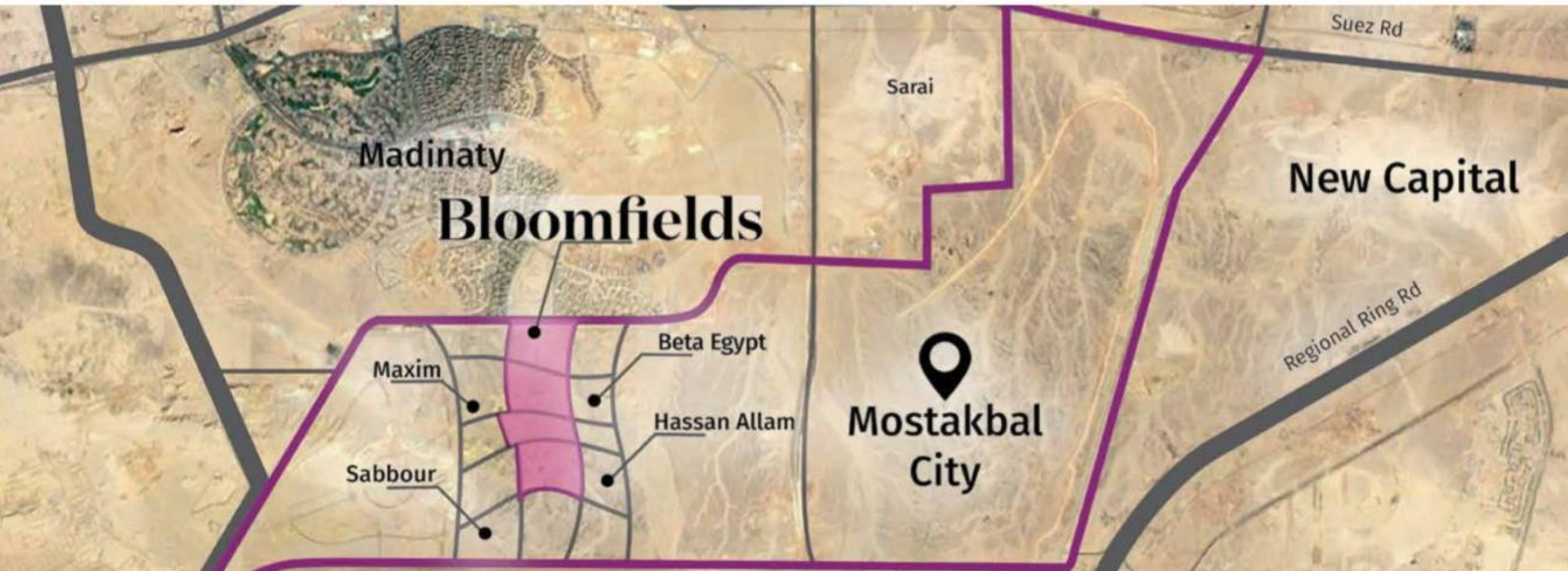



Masterplanned by world-renowned Italian architect Gianluca Peluffo and Partners in collaboration with internationally acclaimed Egyptian architect Raef Fahmy, BLOOMFIELDS is inspired by the tree of life, and the natural balance it represents. Artistically conceived to branch out, unfolding a fully integrated town, BLOOMFIELDS' lively centre is grounded by an impressive college town spreading out to boast a variety of gated residential neighbourhoods. The project's masterplan is peacefully nestled into lush open fields to afford total privacy and equal views for all residents alike, while providing unmatched interconnectivity through action-packed linked bridges that take integrated living to new heights.



Apartments Areas

- One Bedroom 76m to 83m
- Two Bedrooms 105m to 153m
- Three Bedrooms 149m to 240m

- Starting from 1.156.000
- Starting from 1.717.000
- Starting from 2.300.000

Units Types

- Core And Shell
- Semi Finished
- Fully Finished By Mona Hussein Design House



Clusters Zone





Downtown
Zone





TR2

TR1

TR8

TR9

The Vues Zone



YOUR HOME IS READY FOR YOU

For all the different tastes and needs, The Vues fully finished apartments cater to them all efficiently. Choose Modernized Contemporary or Ultra-Modern interiors for your signature-designed home by Mona Hussein Design house, ranging from 1-bedroom to 3-bedroom apartments.



Educational Zone

<https://youtu.be/KwDes-BI9XI>

16 | THE HEART OF IT ALL



BLOOMFIELDS
COLLEGE TOWN

BLOOMFIELDS is the town to share ideas, create, but most importantly grab a piece of the magic that balances the best of community living, studying and work — all artfully combined under one roof.

Boasting Egypt's first entrepreneurial university, a lively college town, internationally acclaimed schools, and a cutting-edge Business Park, BLOOMFIELDS is set to become Egypt's hotbed for startups and entrepreneurs.